

Milestones of Labour

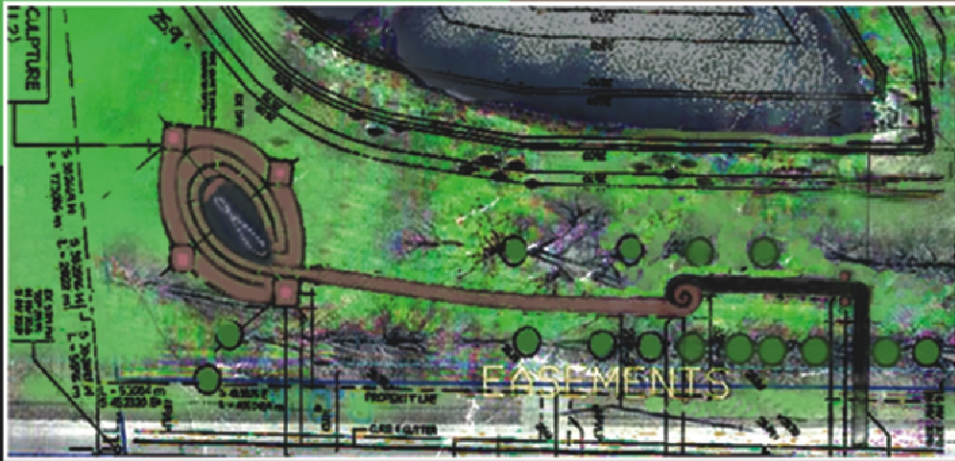

This monument was conceived jointly by the Brampton/Mississauga and District Labour Council, The City of Brampton and artists Rob Moir and Sally Lawrence to commemorate union accomplishments, promote Health and Safety in the Workplace and celebrate work and community.

A spirit of collaboration for the greater good of the larger community has permeated the entire project. To date, many generous donations have been made from industry such as Owen Sound Ledgerrock and Hanson Brick, from schools such as The Canada Masonry Centre/Ontario Masonry Training Centre and Humber College and from the Membership of the Ironworkers Local 721 in Ontario to name a few.

Such donations in the form of professional guidance, materials and labour are greatly appreciated and more are anticipated as the installation draws near. A solemn and meditative mood will be enhanced for the visitor by first passing through beautiful gates and then walking down a tree lined promenade. The visitor will walk a small spiral at the Contemplation Circle where the many donors and donations will be honoured before proceeding past a lovely pond toward the labyrinth.



989 Derry Rd. E., Ste 403
Mississauga, ON L5T 2J8
www.bmdlc.ca

Phone: (905) 696 - 7444

*"You work that you may keep pace with the earth
and the soul of the earth. For to be idle is to become
a stranger unto the seasons and to step out of life's
procession that marches in majesty and proud
submission towards the infinite."*

Kahlil Gibran "The Prophet"



Milestones of Labour



The Analemma

If the sun were observed and recorded each day at true noon for a year, the resulting shape of its movement across the sky would be a figure eight or Analemma. This sign of infinity will be marked on the ground with field stones inlaid with geode crystals. The noon time sun will beam through a small hole in the brick dome causing the geodes to sparkle as the sunlight follows this path over the course of the year. Dates that are relevant to Labour and the community will be mapped on this path and highlighted with plaques. A special beam of rainbow light will mark April 28th; the National Day of Mourning for Workers Killed or Injured in the Workplace. This coloured ray will be generated by a prism inside of the Rainbow Tube that the life-sized welded figures will carry and direct from the top of the dome.

Some suggested dates are:

- April 28th - Day of Mourning
- May 1st - International Workers Day
- June 21st - National Aboriginal Day
- First Monday in September - Labour Day
- September 8th - International Literacy Day
- October 17th - International Day for the Eradication of Poverty
- December 6th - National Day of Remembrance and Action on Violence Against Women
- December 10th - International Human Rights Day
- March 8th - International Woman's Day
- March 21st - International Day for the Elimination of Racial Discrimination



The sculpture depicts three life-size, welded, nickel-silver figures of different ages, genders and ethnic backgrounds climbing the curve of a dome that is part of a structure reminiscent of a brick kiln. Local century farm houses inspired this and the pillars that mark the four directions while honouring one of Brampton's oldest and continuing businesses; brick. Inside the kiln is a brick relief and mosaic that highlights some of the history of local working people for over one hundred years.

This includes the agricultural, flower, automobile, telecommunications and aerospace industries to name a few. Contained within a uniquely designed brick and granite multi-levelled labyrinth is a special sundial called an Analemma. An Analemma is a figure-eight shaped path that traces the movement of the noon time sun over the course of the year. Special dates relevant to labour and society as a whole are marked by geode crystals set into field stone and black granite.

At true noon the sunlight makes the geodes sparkle thereby highlighting specific dates in the year. At 11 am on April 28th, the visitor can experience the appearance of a rainbow in the heart of the Analemma. The metal figures support a "Rainbow Reflector" that directs a ray of coloured light onto a plaque commemorating the National Day of Mourning. Kahlil Gibran's wise words about work guide the visitor through the labyrinth.

There is also a chronological timeline of Union Contributions to work over the past one hundred years woven amongst a memorial to those who have perished in the workplace. The meditative and healing nature of the labyrinth walk and the enchanting spectacle of cast light help the observer to slow down and directly experience the movement of the sun and the rhythm of the day and seasons in relation to the four directions. In this way the sculpture is a place for education, healing and reflection on the nature of work and its relation to community.